

ADA-S2

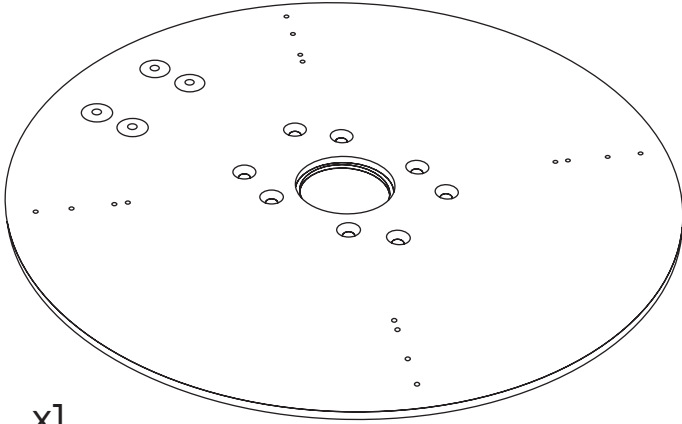

x1

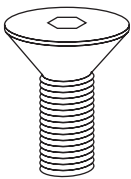

5/16-18 x 1"

x8

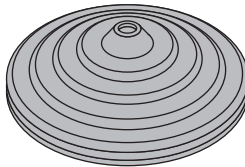

x1

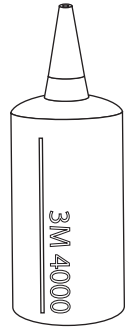
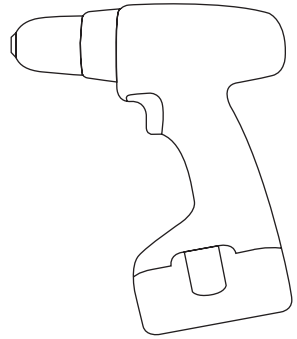
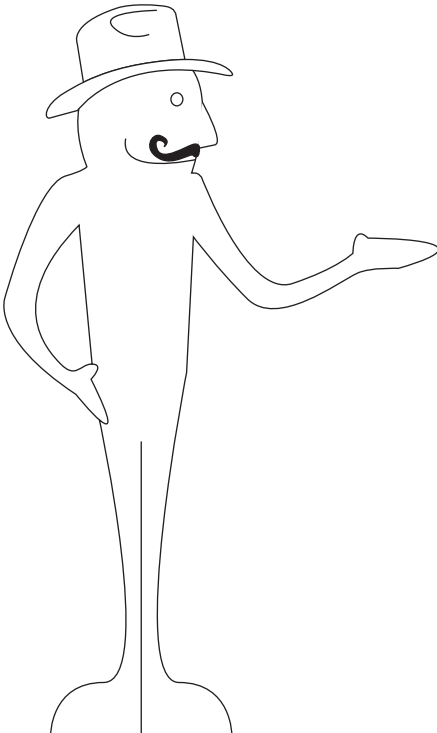
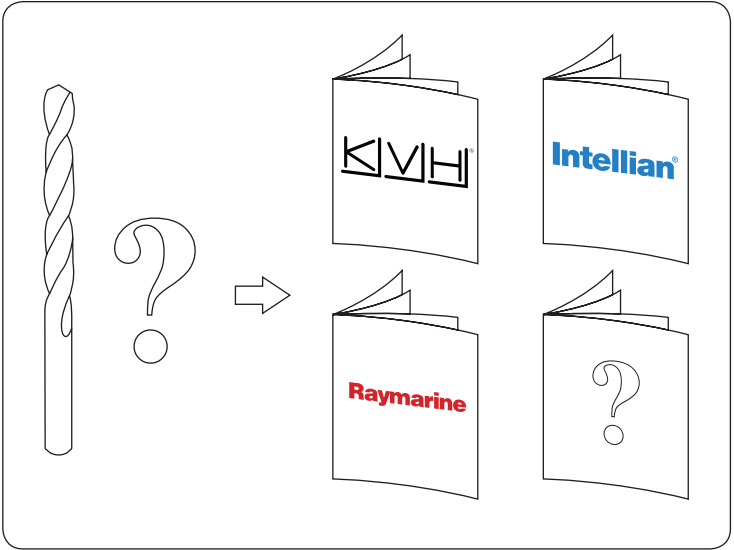

1

1

Intellian i6, i6P, k6, d6, S6HD, FB500
KVH M5, TV5, FB250(18"), M7, M7SK,
HD7, V7, TV6, FB500(26"), V3-IP(24")
Raymarine 60STV

2

VDO Ocean Line 345, 360, 445 ,460

3

Intellian i4, i4P, k4, d4, i5
KVH M5, TRAC 50, TV5, FB250(18")
Raymarine 45STV
SEA-TEL (COBHAM) ST14, FX150, C18, FX250

4

KVH TracPhone V7-IP

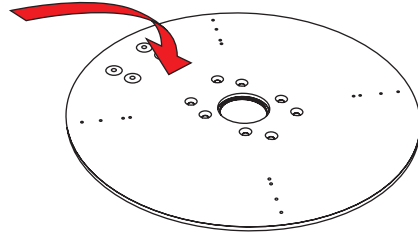
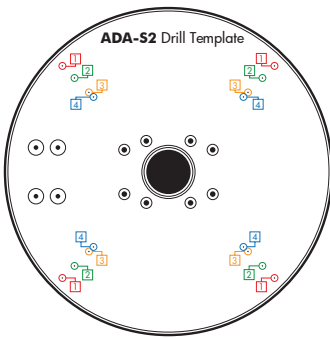

2

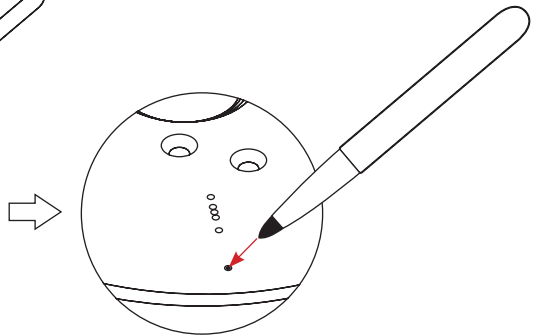
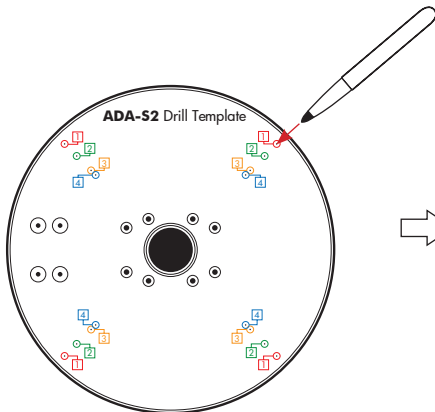

3

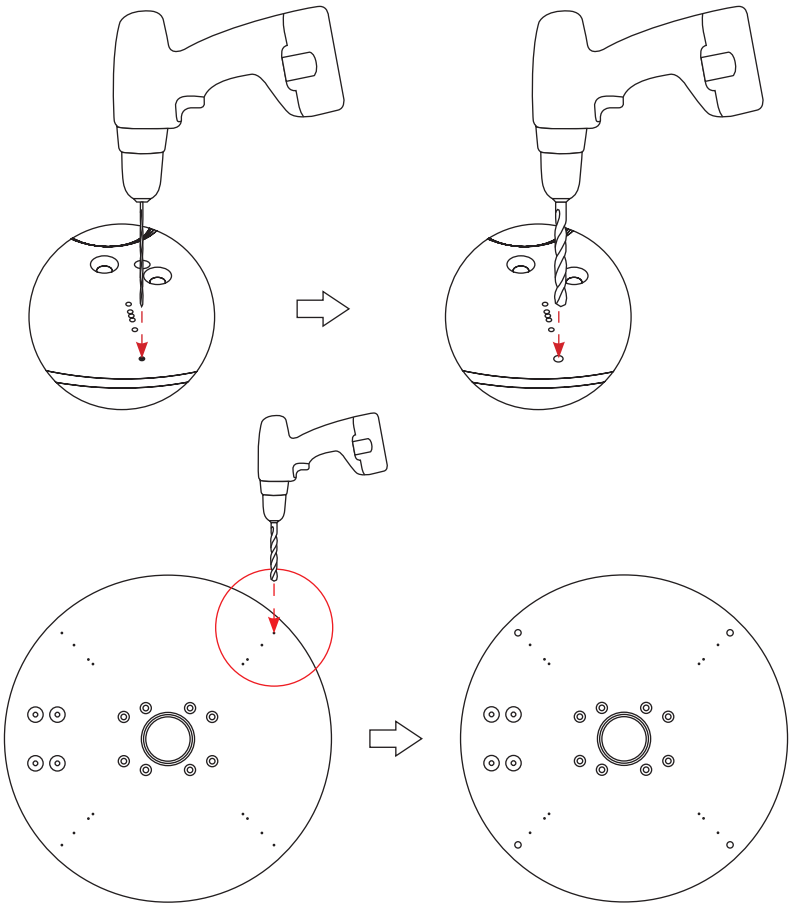

4

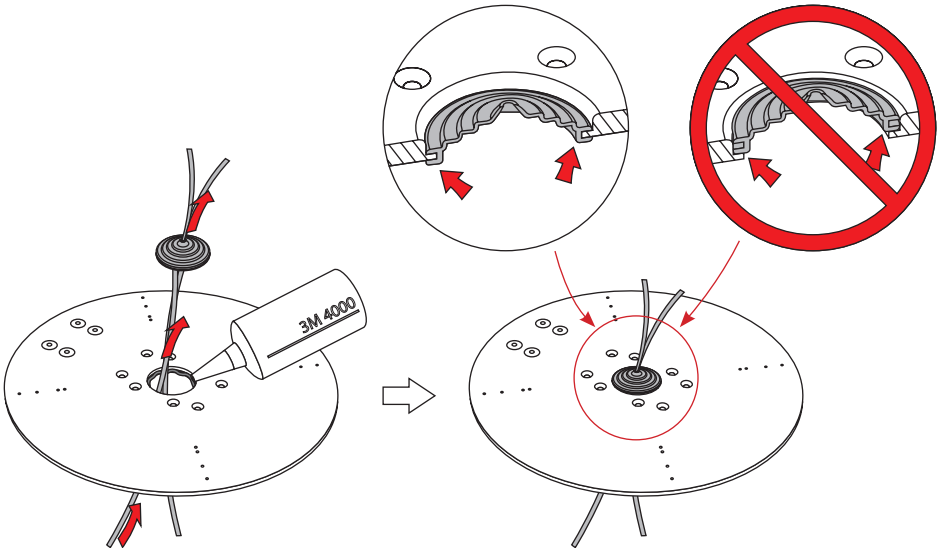

ADA-S2

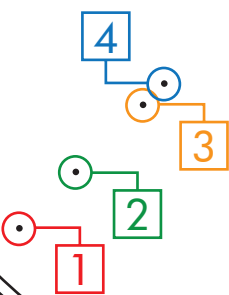
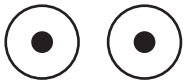
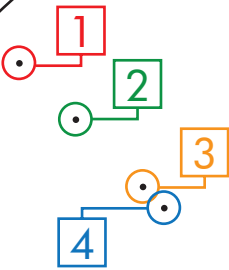

NOT to scale

Drill Template

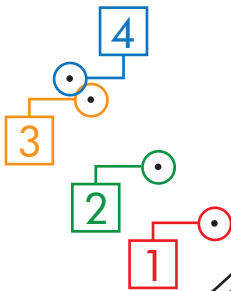



North American Office

12532 Beverly Park Road,
Lynnwood, WA 98087
Tel: 800-523-7558
Fax: 425-355-3661
www.seaviewglobal.com

European Office

Tel: +33 4 94 53 27 70
Fax: +33 4 94 53 26 62
ZI Du Capitou, 85 Rue Louis
Lepine, Frejus 83600 - France
www.seaviewprogress.com