

# 8. INSTALLATION AND WIRE CONNECTION

## 1. Before Starting

1. This set is exclusively for use in vessels with a negative ground 12 V power supply.
2. Read these instructions carefully.
3. Be sure to disconnect the battery “-” terminal before starting. This is to prevent short circuits during installation. (Figure 1)

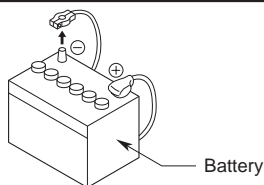

Figure 1

## 2. General Precautions

1. Do not open the case. There are no user serviceable parts inside. If you drop anything into the unit during installation, consult your dealer or an authorized **Clarion** service center.
2. Use a soft, dry cloth to clean the case. Never use a rough cloth, thinner, benzene, or alcohol, etc. For tough dirt, apply a little cold or warm water to a soft cloth and wipe off the dirt gently.

## 3. Installation Precautions

1. Prepare all articles necessary for installing the source unit before starting.
2. Install the unit within 30° of the horizontal plane. (Figure 2)
3. If you have to do any work on the vessel body, such as drilling holes, consult your vessel dealer beforehand.
4. Use the enclosed screws for installation. Using other screws can cause damage. (Figure 3)

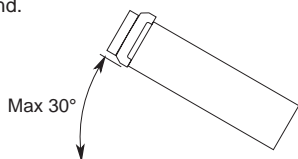

Figure 2

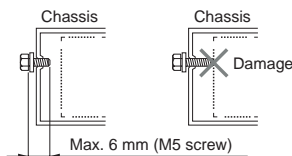
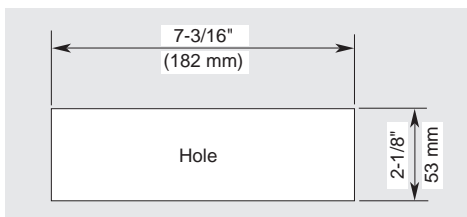

Figure 3

## 4. Installation of the Source Unit

1. Place the mounting bracket into the instrument panel; use a screwdriver to bend each stopper of the mounting bracket inward, then secure the stopper.
2. Wire as shown in Section 7.
3. Insert the source unit into the mounting bracket until it locks.
4. Take care with the top and bottom of the trim ring and mount it so that all the hooks are locked.

### • Console opening dimensions



**Note:** 1. Some vessel models require special mounting kits for proper installation. Consult your **Clarion** dealer for details.

2. Fasten the front stopper securely to prevent the source unit from coming loose.

**Installation notes:**

- Before installation, please make sure proper connections are made and the unit operates normally. Incorrect connection may result in damage to the unit.
- Use only accessories designed and manufactured for this unit as other unauthorized accessories may result in damage to the unit.
- Before installation, please connect all power cables.
- DO NOT install the unit close to hot areas to prevent damage to electrical components such as the laser head.
- Install the unit horizontally. Installing the unit at a vertical angle of more than 30 degrees may result in poor performance.
- To prevent electric sparks, connect the positive pole first and then the negative pole.

**Unit installation****Method A**

1. Insert the mounting bracket into the dashboard, choose the appropriate mounting tab according to the gap width and bend the mounting tab outwards with a screwdriver to fix the mounting bracket in place.
2. Slide the unit into the bracket until you hear a click.

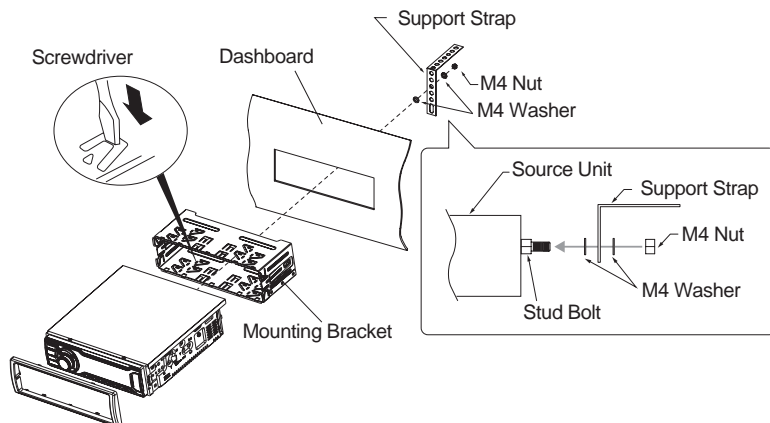
**Method B**

1. Insert this unit directly into the opening in the dashboard.
2. Place M5 × 7 cylindrical screws through the holes in the mounting frame located inside the opening to the holes of the unit and fasten the screws to left & right.

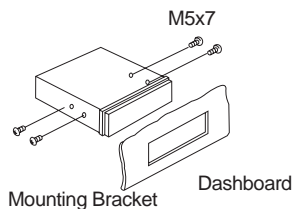
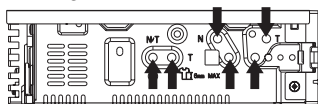
**Trim ring installation**

Attach the trim ring around the front panel. Take care with the top and bottom of the trim ring and mount it so that all the hooks are locked.

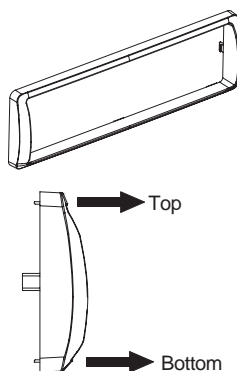

# 5. WIRE CONNECTION

